



# SEAT-741

## Yamaha G14-G22

### RHOK SS Seat Kit

### Installation Instructions

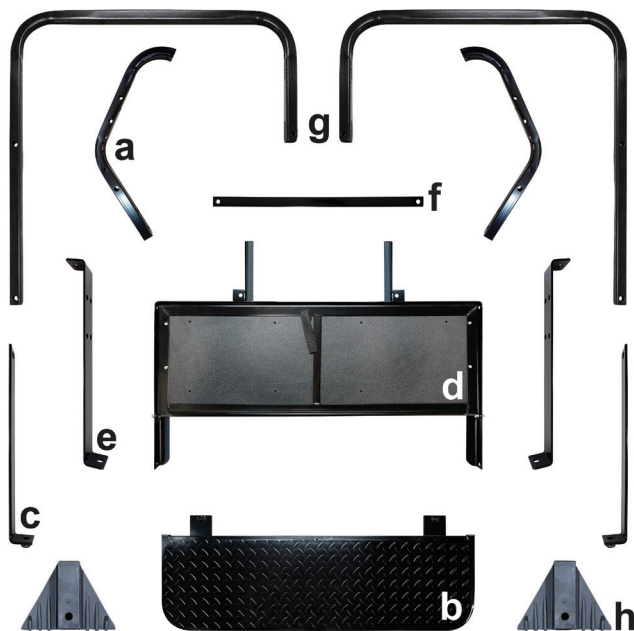

#### Contents of SEAT-741 Rear Seat Kit:

- a 2 ea. Front Seat Back Supports
- b 1 ea. Footplate
- c 2 ea. Vertical Support Brackets
- d 1 ea. Seat Platform
- e 2 ea. Rear Seat Back Brackets
- f 1 ea. Horizontal Alignment Bar
- g 2 ea. Handrails
- h 2 ea. Footplate Support Brackets
- i 1 ea. Bag of Hardware (Contents on Next Page)

**NOTE:** Carts with non-collapsible struts require TOP-0105 Top Struts for OE Top (not included).

**Caution:** Please read through the instructions carefully. Installer is responsible for damage if instructions are not followed properly. Look behind each drill or cut location BEFORE YOU DRILL OR CUT. Installer is responsible for damage (i.e. drilling/cutting into a wiring harness, battery, fuel tank etc.). Extra installers will be helpful in some parts of the installation. Refer to vehicle's maintenance manual for torquing specifications on reused hardware.

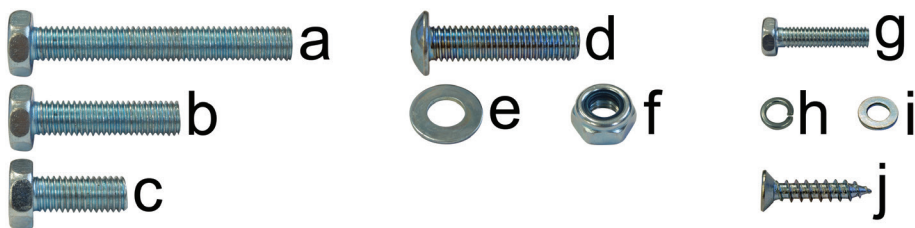

Contents of SEAT-741 Hardware Kit		Bag #1	#2	#3	#4	#5
a	M10-1.5 x 70 Hex Head Bolts				2	
b	M10-1.5 x 40 Hex Head Bolts		6			
c	M10-1.5 x 25 Hex Head Bolts	6				
d	M10-1.5 x 40 Phillips Head Truss Bolts			4		
e	M10 Flat Washers	10	10	4	4	
f	M10-1.5 Nylock Nuts	4	4	4	2	
g	M6-1.0 x 25 Hex Head Bolts					4
h	M6 Lock Washers					4
i	M6 Flat Washers					4
j	#10 x 1.25" Wood Screws					8

### Tools Needed for Installation

- Sockets and Open Ended Wrenches (10mm, 12mm, 1/2", 17mm)
- Allen Wrenches (5mm)
- Phillips Screwdriver
- Drill and Drill Bit (5/16")
- Saw with Metal Blade (Optional)
- Rubber Mallet (Optional)

### Installation Preparation

1. Engage parking brake.
2. Turn key OFF.
3. Electric Carts Only: Place Tow/Run Switch in Tow.
4. Remove top.

Carts with Non-Collapsible Struts: The factory struts will need to be modified in order to be reused.

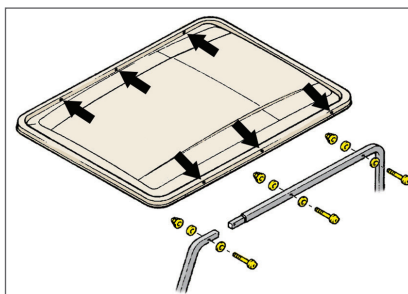

Carts with Non-Collapsible Struts  
(Driver Side)

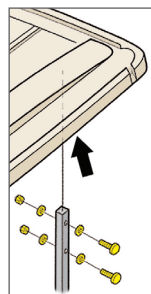

Carts with Collapsible Struts  
(Driver Side)

Carts with Collapsible Struts: If reinstalling the top, keep the top attached to the front struts and prop up the rear of the top using a broom handle or similar tool. Retain hardware.

5. Remove the front seat back cushions (red arrows). Retain hardware.
6. Remove rear struts and sweater basket (black arrows). Retain hardware.

Carts with Non-Collapsible Struts:  
Sweater basket can be removed with rear struts. Requires TOP-0105 (sold separately) rear struts if reinstalling factory top.

Carts with Collapsible Struts:  
Sweater basket can be removed separately or with the front seat back supports. Reuse factory rear struts if reinstalling factory top.

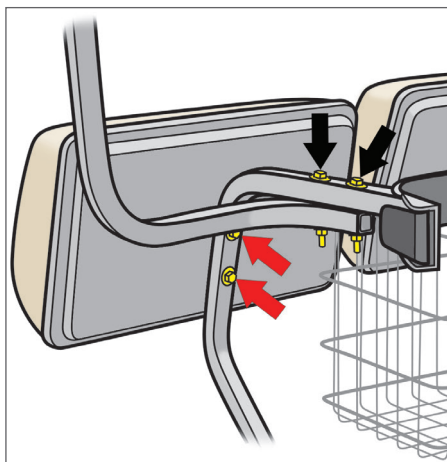

7. Remove the access panel. Retain rivets.

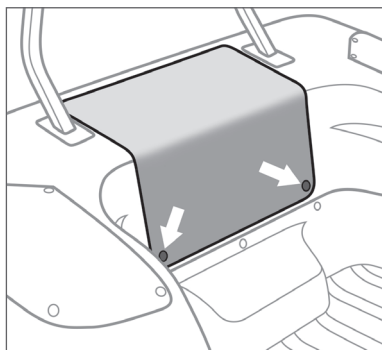

8. Remove the seat back support. Retain hardware.

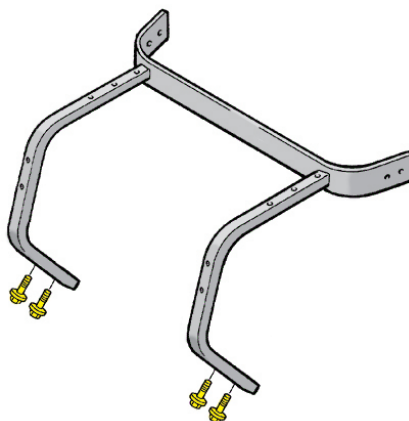

9. Remove rear bumper. Discard hardware.

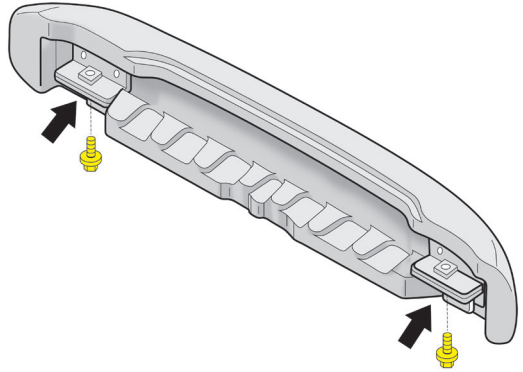

## Rear Seat Kit Installation

1. Install the new front seat back supports where the original bracket was installed. Mount using the Original Hardware.
2. Reinstall the access panel using the Original Hardware.

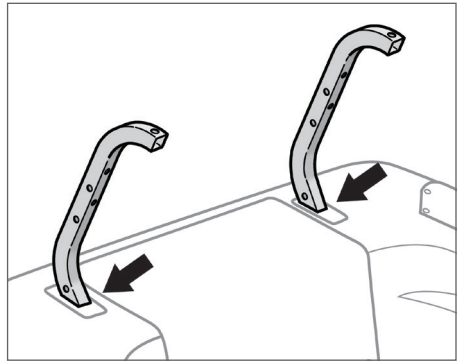

3. Install the footplate to the frame where the rear bumper was removed using (2) M10 x 25 Hex Head Bolts and (2) Flat Washers (**Bag #1**).

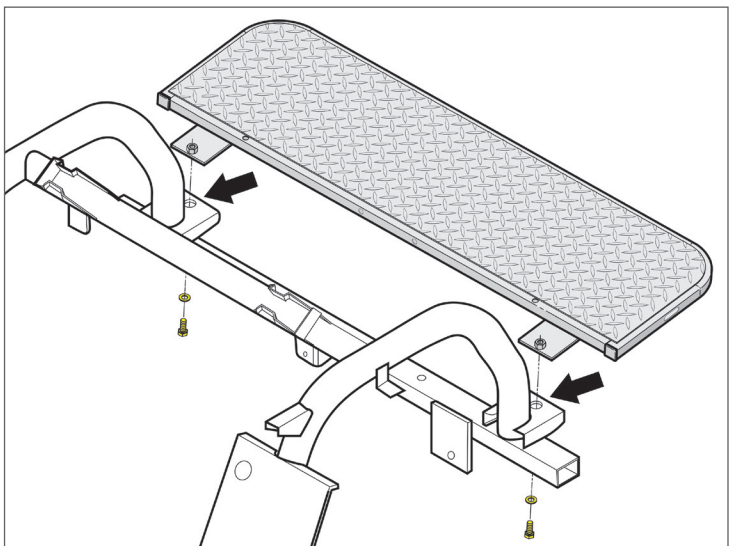

4. Loosely fasten the vertical support brackets to the footplate using (2) M10 x 40 Hex Head Bolts and (2) Flat Washers (**Bag #2**).

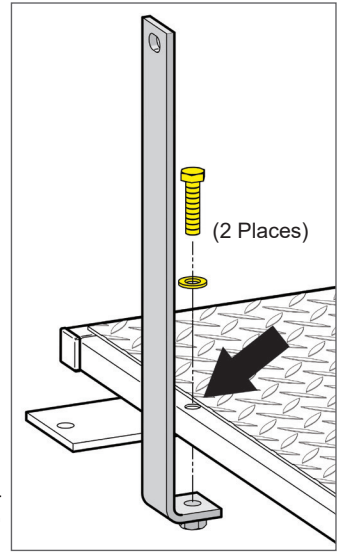

5. Loosely install the seat platform to the front seat back support brackets using (2) M10 x 40 Hex Head Bolts, (4) Flat Washers and (2) Nylock Nuts (**Bag #2**, black arrows).

**NOTE:** Protect the rear body from scratches with a thick blanket or clean piece of cardboard. An extra installer is recommended on this step.

6. With the platform folded, loosely install the seat platform to the vertical support brackets using (2) M10 x 25 Hex Head Bolts, (4) Flat Washers and (2) Nylock Nuts (**Bag #1**, red arrows).

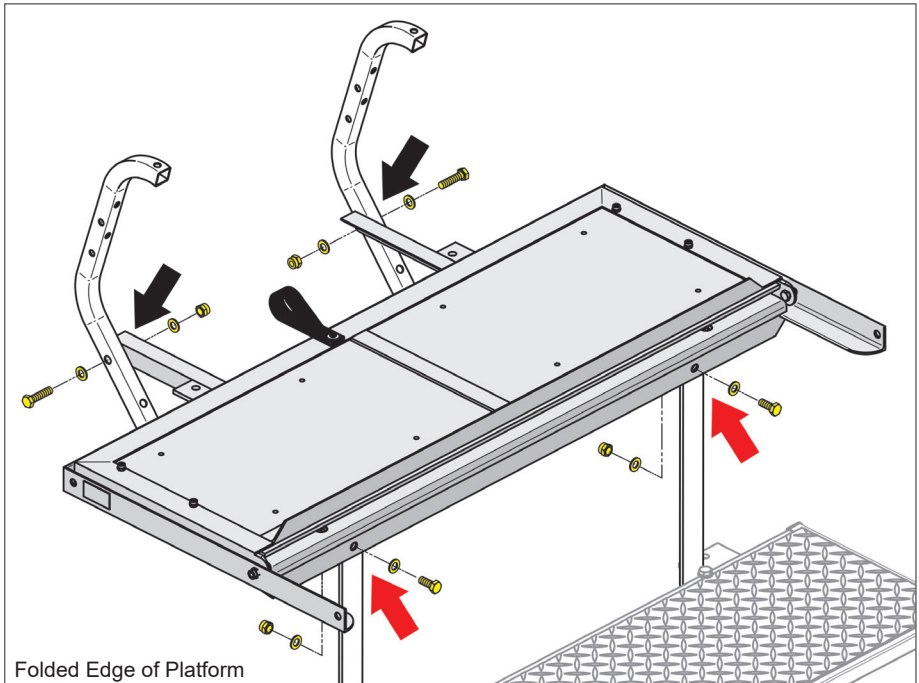

7. Loosely install the rear seat back brackets and horizontal alignment bar to the top of the front seat back supports using (2) M10 x 40 Hex Head Bolts, (4) Flat Washers and (2) Nylock Nuts (**Bag #2**, black arrows).
8. Loosely install the rear seat back brackets to the seat platform using (2) M10 x 25 Hex Head Bolts, (4) Flat Washers and (2) Nylock Nuts (**Bag #1**, red arrows).

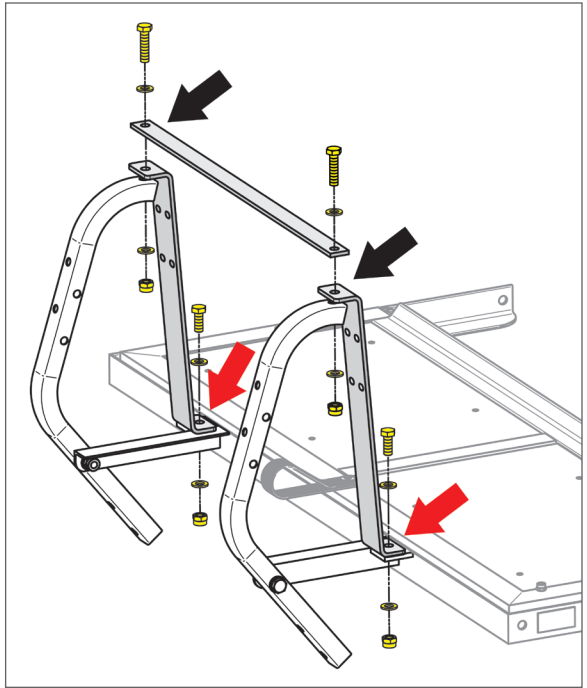

9. Loosely fasten the upper portion of a handrail to the seat platform (blue arrows) using (2) M10 x 40 Phillips Head Truss Bolts, (2) Flat Washers and (2) Nylock Nuts (**Bag #4**).
10. Slide a footplate support bracket over the long end of a handrail until the holes align (black arrow). The bracket will cradle the footplate. Loosely fasten the bracket and handrail to the footplate using (1) M10 x 70 Hex Head Bolt, (2) Flat Washers and (1) Nylock Nut (**Bag #4**).
11. Repeat Steps 9 and 10 for the opposite handrail.
12. Install the front seat back cushion using the Original Hardware.

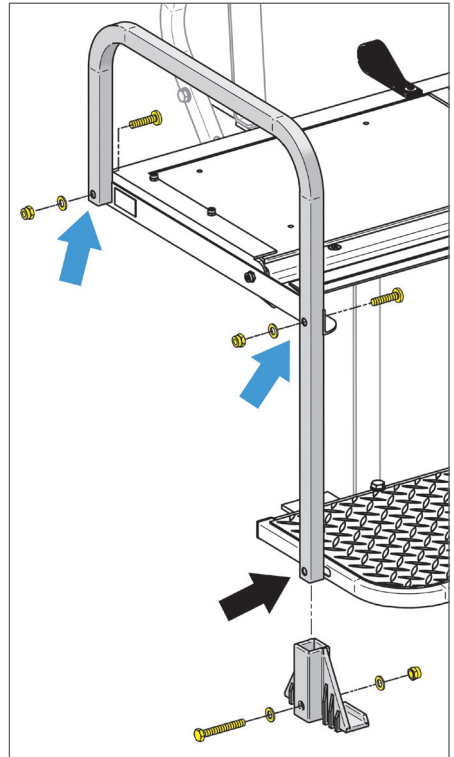

**NOTE:** Loosen the seat back supports if the holes do not align.

13. Install the rear seat back to the rear seat back brackets using (4) M6 x 25 Hex Head Bolts, (4) Lock Washers and (4) Flat Washers (**Bag #5**). Hand tighten.

14. Tighten all hardware.

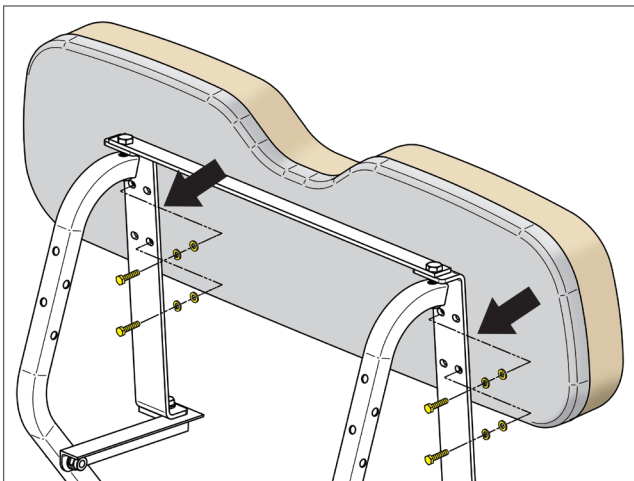

15. Carts with Collapsible Struts and OE Top:  
Install the OE rear struts to the front seat back supports (red arrows) using the Original Hardware.

Carts w/o Collapsible Struts and OE Top:

Install TOP-0105 (sold separately) to the front seat back supports (red arrows). Modify the OE struts as shown to reuse as front and middle portions of struts to support top.

Carts with RHOX 88" Top:

Install TOP-0108 rear struts (sold separately) to the handrails (black arrows). Drilling required. For carts without collapsible struts, modify the OE struts as shown to reuse as front and middle portions of struts to support top.

16. Install the top using Original Hardware (if applicable).

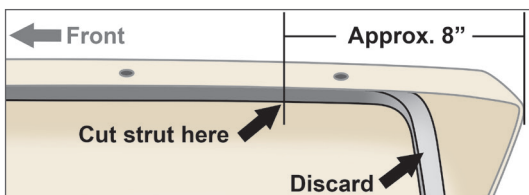
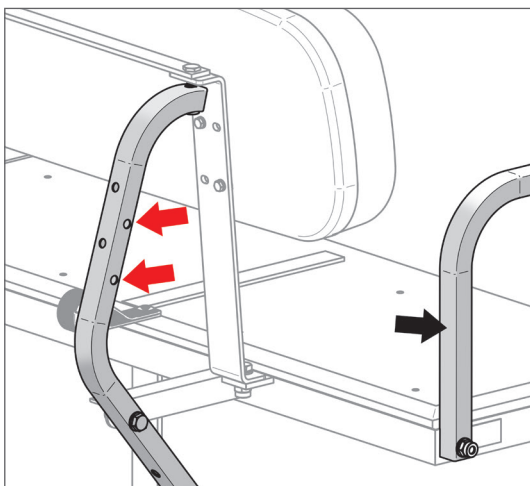

17. Align the seat bottom cushion with the holes on the platform. Fasten the seat bottom cushion to the platform using (8) #10 x 1.25" Wood Screws (**Bag #5**). Hand tighten.

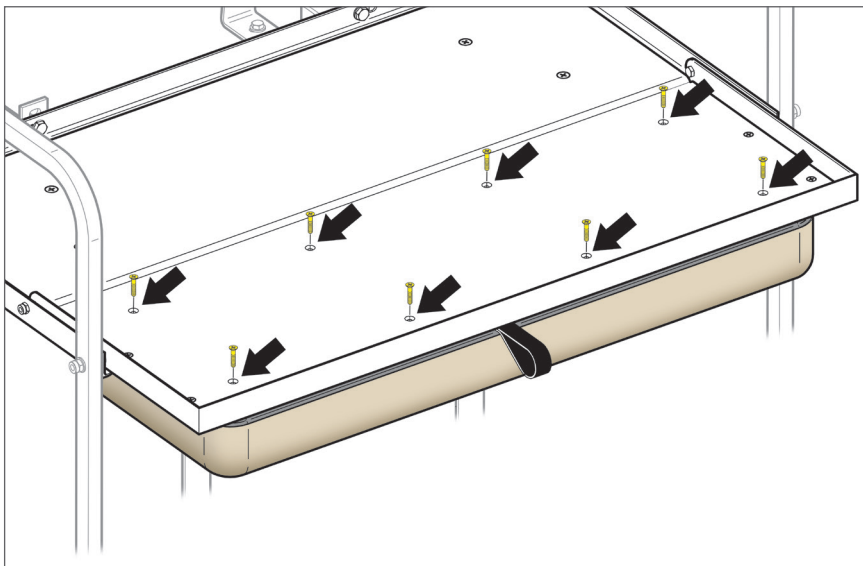

18. Tighten all hardware.

**RUGGED  
STARTS  
HERE**

This completes the installation of your  
RHOX 700 Series SS Rear Seat Kit. Please enjoy safely!

Scan QR code or use the link to view our installation video library.  
<https://www.youtube.com/user/golfcartinstructions>

