



SEAT-931

Club Car Precedent

RHOX 900 Series Seat Box Kit

Installation Instructions

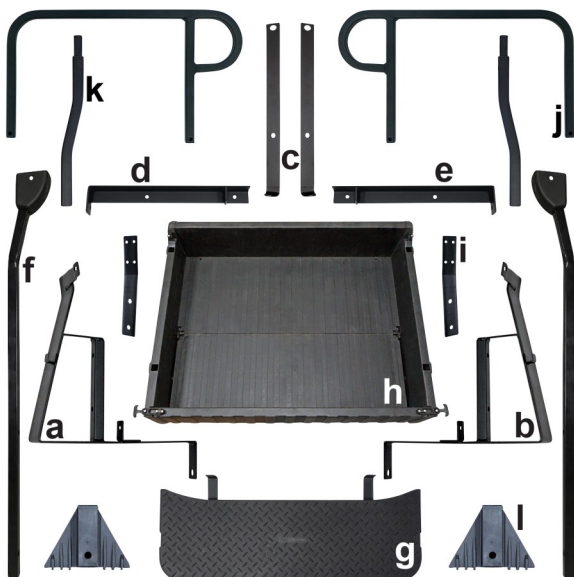

Contents of SEAT-931 Seat Box Kit:

- a (1 ea.) Front Seat Back Support, Passenger Side
- b (1 ea.) Front Seat Back Support, Driver Side
- c (2 ea.) Vertical Support Brackets
- d (1 ea.) Horizontal Support Bracket, Passenger Side
- e (1 ea.) Horizontal Support Bracket, Driver Side
- f (2 ea.) Replacement Rear Struts for OE Top
- g (1 ea.) Footplate
- h (1 ea.) Utility Box
- i (2 ea.) Rear Seat Back Brackets
- j (2 ea.) Handrails
- k (2 ea.) Handrail Extensions
- l (1 ea.) Footplate Support Brackets
- m (1 ea.) Box of Hardware (Contents on Next Page)

Caution: Please read through the instructions carefully. Installer is responsible for damage if instructions are not followed properly. Look behind each drill or cut location BEFORE YOU DRILL OR CUT. Installer is responsible for damage (i.e. drilling/cutting into a wiring harness, battery, fuel tank etc.). Extra installers will be helpful in some parts of the installation. Refer to vehicle's maintenance manual for torquing specifications on reused hardware.

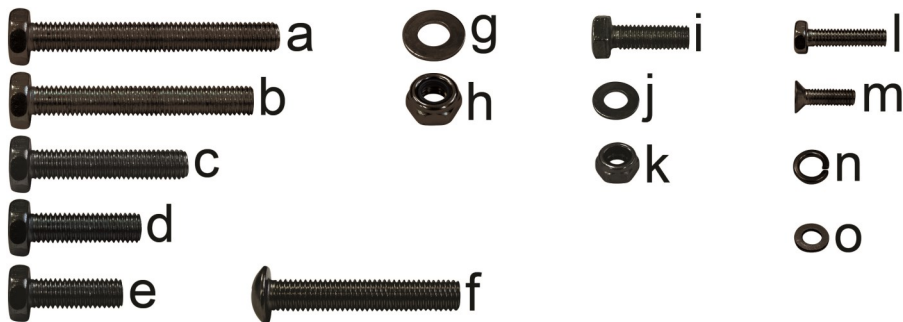

Contents of SEAT-931 Hardware Kit		Bag #1	#2	#3	#4	#5
a	M10 x 80 Hex Head Bolts			2		
b	M10 x 70 Hex Head Bolts	4				
c	M10 x 50 Hex Head Bolts	2				
d	M10 x 35 Hex Head Bolts		2			
e	M10 x 30 Hex Head Bolts	2	4			
f	M10 x 60 Phillips Head Countersunk Screws		2			
g	M10 Flat Washers	16	12	4		
h	M10 Nylock Nuts	8	6	2		
i	M8 x 25 Hex Head Bolts				4*	
j	M8 Flat Washers				8*	
k	M8 Nylock Nuts				4	
l	M6 x 25 Hex Head Bolts					4
m	M6 x 15 Phillips Head Countersunk Screws					4*
n	M6 Lock Washers					4
o	M6 Flat Washers					4

* Hardware is pre-installed on box if not in bags.

Tools Needed For Installation

- Sockets and Wrenches: 8mm, 10mm, 13mm, 17mm
- Torx Bit Socket: T40
- Phillips Head Screwdriver
- Drill and Drill Bit (3/8")
- Rubber Mallet (Optional)

Installation Preparation

1. Engage parking brake.
2. Turn key OFF.
3. Electric Carts Only: Place Tow/Run Switch in Tow.
4. Remove canopy (black arrows). Retain hardware.
5. Remove rear struts (red arrow). Hardware is located inside of sweater basket. Discard struts and hardware.

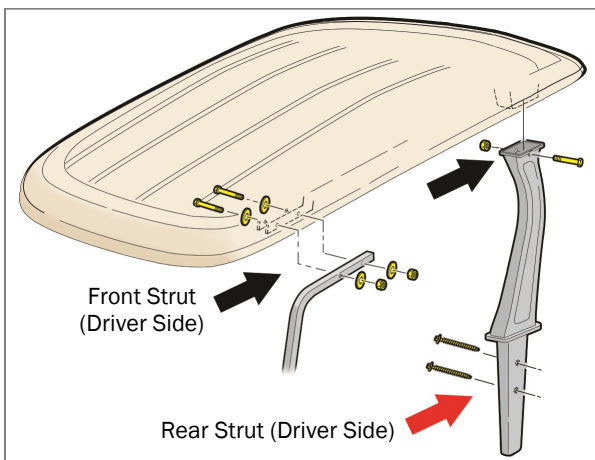

6. Remove the front seat back cushion (black arrows). Retain seat back and hardware.

NOTE: Remove TORX bolts by hand.

7. Remove sweater basket / SAM Assembly (red arrows, 4 bolts total). Discard sweater basket / SAM assembly. Retain hardware.

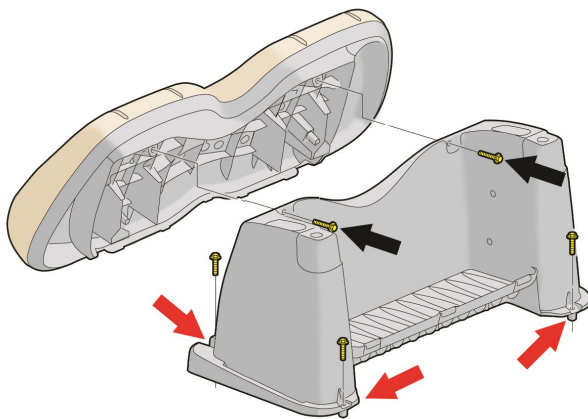

8. Remove both canopy supports. Discard supports and retain hardware.

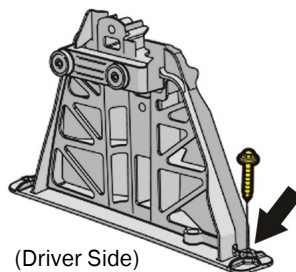

9. Remove the (2) bolts at the top of the bagwell area. Retain hardware.

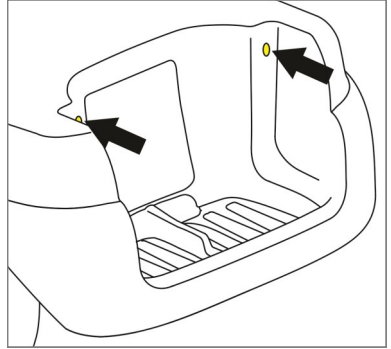

Rear Seat Kit Installation

1. Loosely install the new front seat back supports to the rear body using the Original Hardware.

NOTE: Driver and passenger side brackets are different.

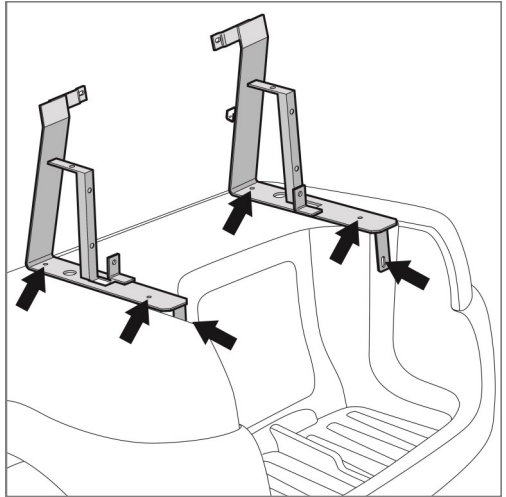

2. Use a 3/8" drill bit to open up the (2) rear and outer most holes in the bagwell area. Drill completely through the rivet and the frame. Driver side hole not shown.
3. Loosely fasten the vertical support brackets to the bagwell area using (2) M10 x 50 Hex Head Bolts, (4) Flat Washers and (2) Nylock Nuts (**Bag #1**).

NOTE: Underbody may have to be trimmed if it gets in the way of the hardware.

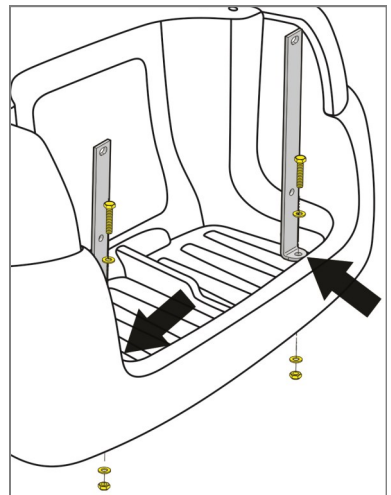

4. Loosely install the horizontal support brackets to the front seat back supports and to the vertical support brackets using (4) M10 x 30 Hex Head Bolts, (8) Flat Washers and (4) Nylock Nuts (**Bag #2**).

NOTE: Driver and passenger side brackets are different.

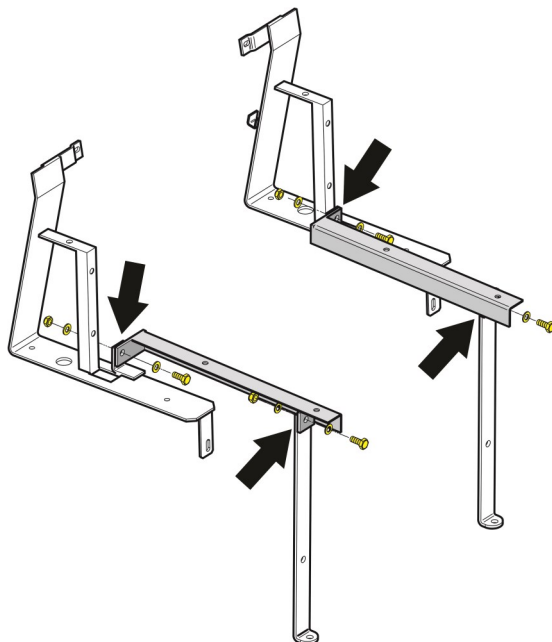

5. If reinstalling the OE top, loosely fasten the replacement rear struts to the front seat back supports using (4) M10 x 70 Hex Head Bolts, (8) Flat Washers and (4) Nylock Nuts (**Bag #1**).

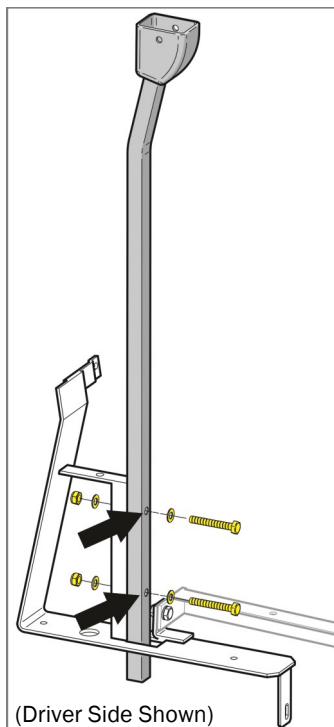

6. Loosely fasten the footplate to the vertical support brackets using (2) M10 x 30 Hex Head Bolts, (4) Flat Washers and (2) Nylock Nuts (**Bag #1**).

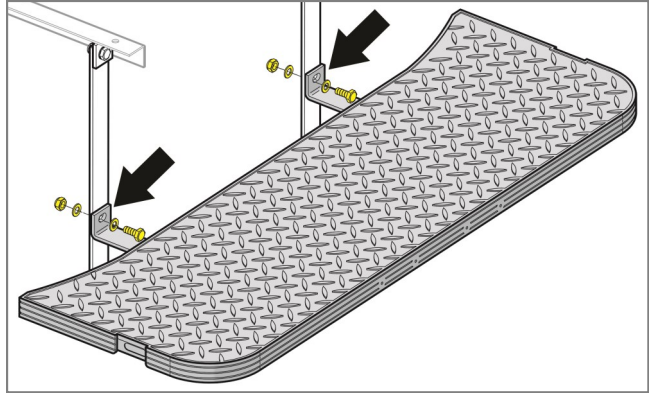

7. Loosely fasten the rear seat back brackets to the rear seat back cushion (4) M6 x 25 Hex Head Bolts, (4) Lock Washers and (4) Flat Washers (black arrows, **Bag #5**).

8. Loosely fasten the seat back assembly to the front of the utility box using (4) M8 x 25 Hex Head Bolts and (4) Flat Washers (red arrows, **Bag #4**).

NOTE: Hardware may be pre-installed on box if not in Bag.

9. Tighten the hardware left loose in Steps 7 and 8.

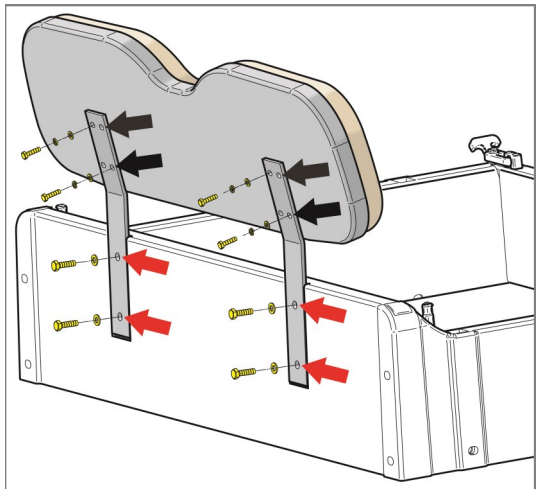

10. Place the seat box assembly on top of the horizontal support brackets. Loosely fasten the box to the brackets using (4) M8 Flat Washers and (4) M8 Nylock Nuts (**Bag #4**).

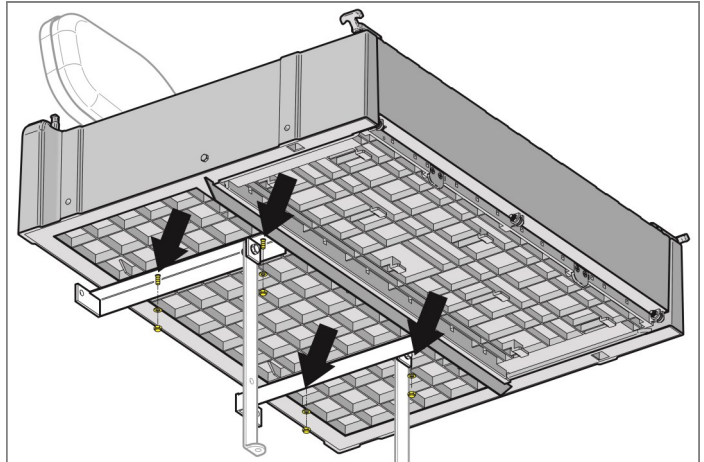

11. Place the handrails and handrail extensions through the openings in the box.
12. Loosely fasten the front portion of the handrails to the box using (2) M10 x 35 Hex Head Bolts and (2) Flat Washers (red arrow, **Bag #2**). Do not overtighten ⚠.
13. Loosely fasten the handrail extensions to the handrails and the box using (2) M10 x 60 Phillips Head Countersunk Screws, (2) Flat Washers and (2) Nylock Nuts (blue arrow, **Bag #2**). Do not overtighten ⚠.
14. Slide the footplate support brackets over the handrail extensions until the holes align. The brackets will cradle the footplate. Loosely fasten the brackets and handrail extensions to the footplate using (2) M10 x 80 Hex Head Bolts (4) Flat Washers and (2) Nylock Nuts (black arrow, **Bag #3**).
15. Install the front seat back cushion using the Original Hardware.
16. Slide the rear seat bottom onto the underside of the utility box deck until it clicks into place on the locking tabs (yellow).

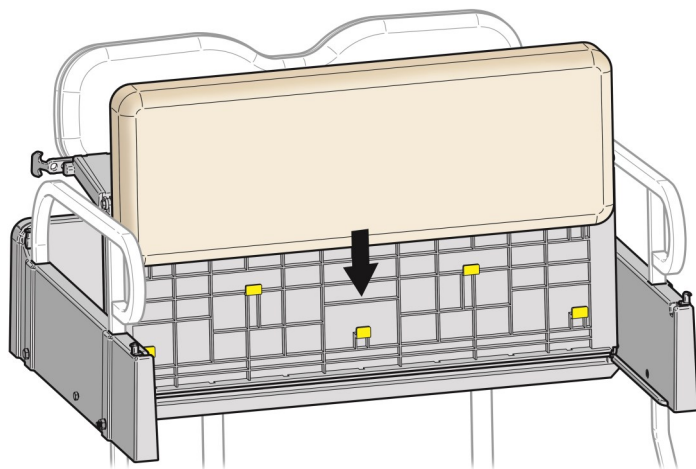
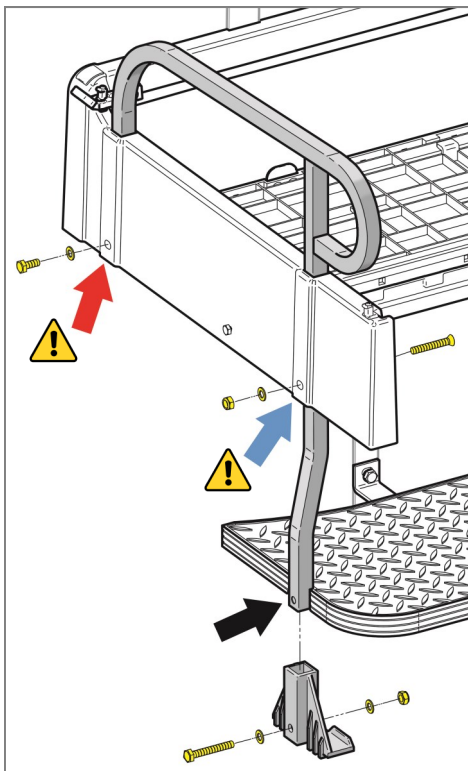

17. Lock the seat bottom into place with the (2) small retaining plates and (4) M6 x 15 Phillips Head Countersunk Screws (**Bag #5**).

NOTE: The retaining plates and screws may be pre-installed on the utility box if not in Bag #5.

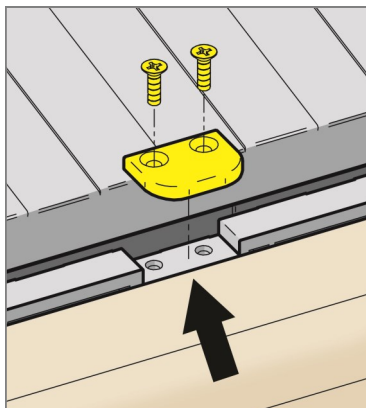

18. If installing struts for an extended top, remove the end caps from the front corners of the utility box.

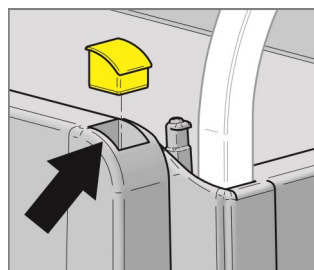

19. Insert the struts inside of the utility box where the end caps were removed. Fasten the struts to the box using the hardware preinstalled on the box. TOP-0108 rear struts are shown.

NOTE: RHOX 88" Tops require TOP-0108 rear struts.

20. Reinstall top using Original Hardware (if applicable).

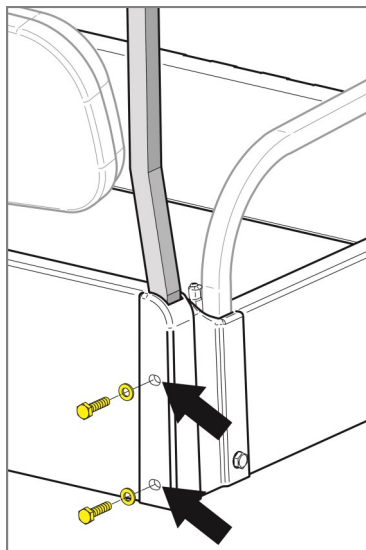

This completes the installation of your RHOX 900 Series Seat Box Kit. Please enjoy safely!

Scan QR code or use the link below to view the installation video.

<https://vimeo.com/user39935056>

