



## SEAT-911

### E-Z-Go TXT

### RHOX 900 Series Seat Box Kit

### Installation Instructions

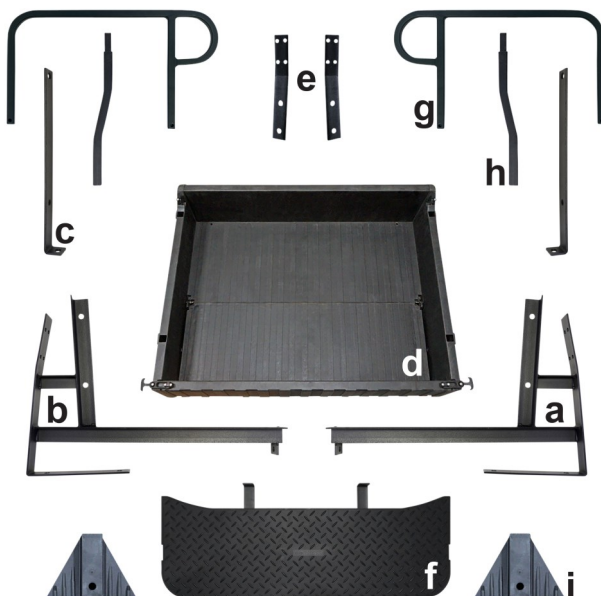

#### Contents of SEAT-911 Seat Box Kit:

- a (1 ea.) Front Seat Back Support Bracket, Passenger Side
- b (1 ea.) Front Seat Back Support Bracket, Driver Side
- c (2 ea.) Vertical Support Brackets
- d (1 ea.) Utility Box
- e (2 ea.) Rear Seat Back Brackets
- f (1 ea.) Footplate
- g (2 ea.) Handrails
- h (2 ea.) Handrail Extensions
- i (2 ea.) Footplate Support Brackets
- j (1 ea.) Box of Hardware (Contents on Next Page)

**Caution:** Please read through the instructions carefully. Installer is responsible for damage if instructions are not followed properly. Look behind each drill or cut location **BEFORE YOU DRILL OR CUT**. Installer is responsible for damage (i.e. drilling/cutting into a wiring harness, battery, fuel tank etc.). Extra installers will be helpful in some parts of the installation. Refer to vehicle's maintenance manual for torquing specifications on reused hardware.

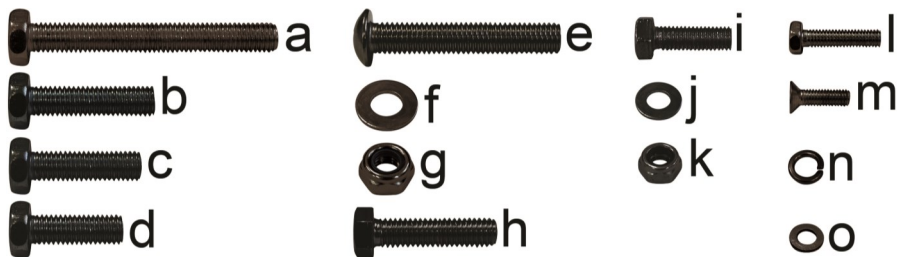

Contents of SEAT-911 Hardware Kit		Bag #1	#2	#3	#4	#5
<b>a</b>	M10 x 80 Hex Head Bolts			2		
<b>b</b>	M10 x 40 Hex Head Bolts	2				
<b>c</b>	M10 x 35 Hex Head Bolts		2			
<b>d</b>	M10 x 30 Hex Head Bolts		4			
<b>e</b>	M10 x 60 Phillips Head Countersunk Screws		2			
<b>f</b>	M10 Flat Washers	8	12	4		
<b>g</b>	M10 Nylock Nuts	2	6	2		
<b>h</b>	3/8-16 x 1.5" Hex Head Bolt	4				
<b>i</b>	M8 x 25 Hex Head Bolts				4*	
<b>j</b>	M8 Flat Washers				8*	
<b>k</b>	M8 Nylock Nuts				4	
<b>l</b>	M6 x 25 Hex Head Bolts					4
<b>m</b>	M6 x 15 Phillips Head Countersunk Screws					4*
<b>n</b>	M6 Lock Washers					4
<b>o</b>	M6 Flat Washers					4

\* Hardware is pre-installed on box if not in bags.

#### Tools Needed For Installation

- Sockets and Open Ended Wrenches: 10mm, 12mm, 7/16", 1/2", 9/16", 17mm
- Phillips Screwdriver
- Drill and Drill Bit (3/8")
- Rubber Mallet (Optional)

### Installation Preparation

1. Engage parking brake.
2. Turn key OFF.
3. Electric Carts Only: Place Tow/Run Switch in Tow.
4. Remove top.

**NOTE:** If reinstalling the top, keep the top attached to the front struts and prop up the rear of the top using a broom handle or similar tool. Retain hardware.

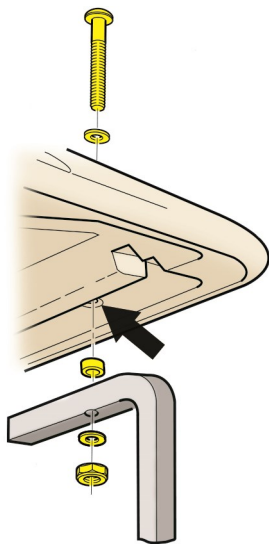

Rear Strut (Driver Side)

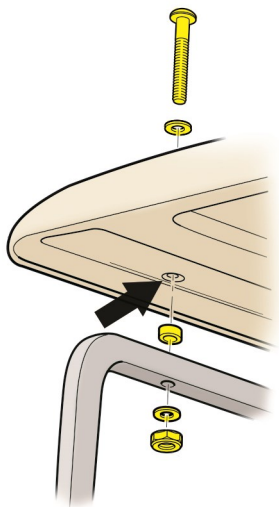

Front Strut (Driver Side)

5. Remove the front seat back cushion (black arrows). Retain hardware.
6. Remove rear struts (red arrows). Retain hardware.

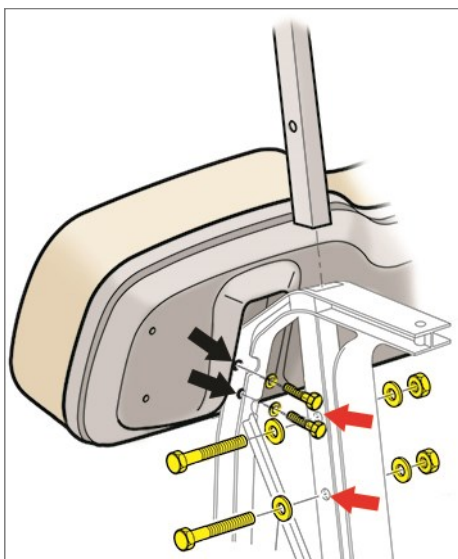

(Driver Side)

7. Remove both seat back supports and the bag attachment. Driver side seat support shown.

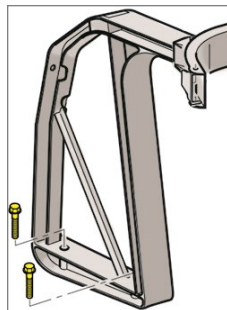

### Rear Seat Kit Installation

1. Use a 3/8" drill bit to open up the (2) rear most holes in the bagwell area. Drill completely through the rivet and the frame.
2. Loosely fasten the vertical support brackets to the bagwell area using (2) 10mm x 40 Hex Head Bolts, (4) Flat Washers and (2) Nylock Nuts (**Bag #1**).

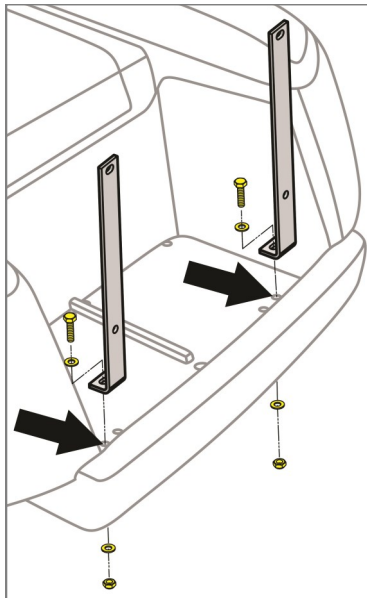

3. Install the new front seat back support brackets where the original brackets were installed. Mount to the rear body using (4) 3/8-16 x 1.5" Hex Head Bolts and (4) Flat Washers (red arrows, **Bag #1**).

**NOTE:** The driver and passenger side brackets are different.

4. Loosely fasten the seat back support brackets to the vertical support brackets using (2) (M10 x 30 Hex Head Bolts, (4) Flat Washers and (2) Nylock Nuts (black arrows, **Bag #2**).

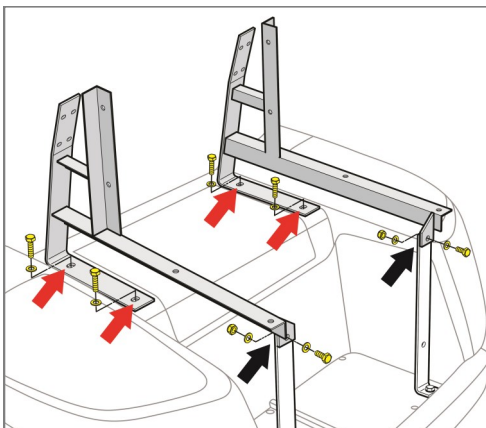

5. Loosely fasten the footplate to the vertical support brackets using (2) M10 x 30 Hex Head Bolts, (4) Flat Washers and (2) Nylock Nuts (**Bag #2**).

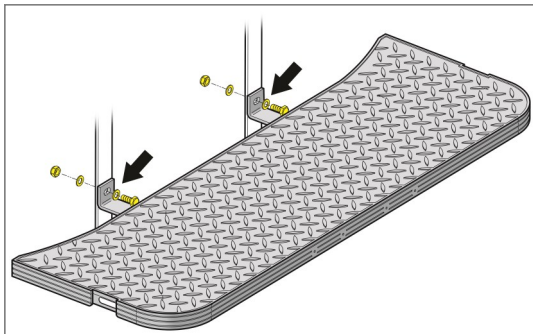

6. Loosely fasten the rear seat back brackets to the rear seat back cushion using (4) M6 x 25 Hex Head Bolts, (4) Lock Washers and (4) Flat Washers (black arrows, **Bag #5**).

7. Loosely fasten the seat back assembly to the front of the utility box using (4) M8 x 25 Hex Head Bolts and (4) Flat Washers (red arrows, **Bag #4**).

**NOTE:** Hardware may be pre-installed on box if not in Bag.

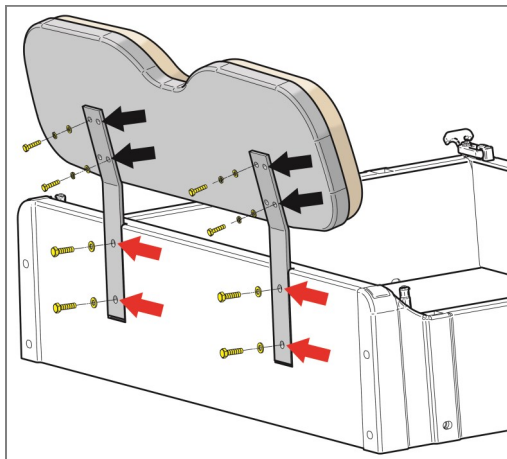

8. Tighten the hardware left loose in Steps 6 and 7.

9. Place the seat box assembly on top of the horizontal support brackets. Loosely fasten the box to the brackets using (4) M8 Flat Washers and (4) M8 Nylock Nuts (**Bag #4**).

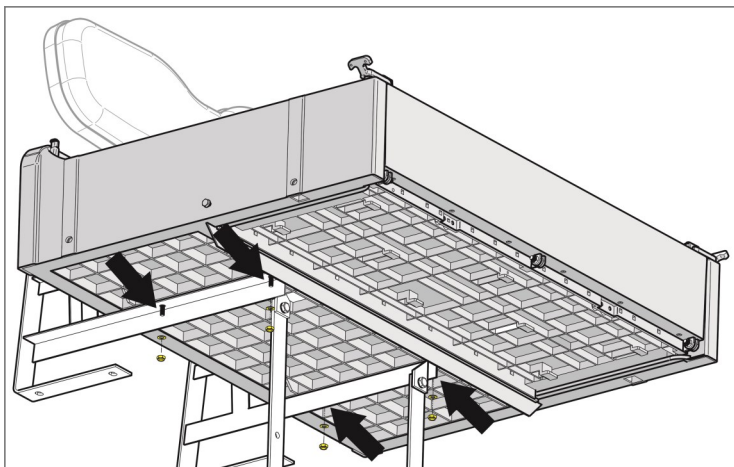

10. Place the handrails and handrail extensions through the openings in the box.
11. Loosely fasten the front portion of the handrails to the box using (2) M10 x 35 Hex Head Bolts and (2) Flat Washers (red arrow, **Bag #2**). Do not overtighten ⚠.
12. Loosely fasten the handrail extensions to the handrails and the box using (2) M10 x 60 Phillips Head Countersunk Screws, (2) Flat Washers and (2) Nylock Nuts (blue arrow, **Bag #2**). Do not overtighten ⚠.
13. Slide the footplate support brackets over the handrail extensions until the holes align. The brackets will cradle the footplate. Loosely fasten the brackets and handrail extensions to the footplate using (2) M10 x 80 Hex Head Bolts (4) Flat Washers and (2) Nylock Nuts (black arrow, **Bag #3**).

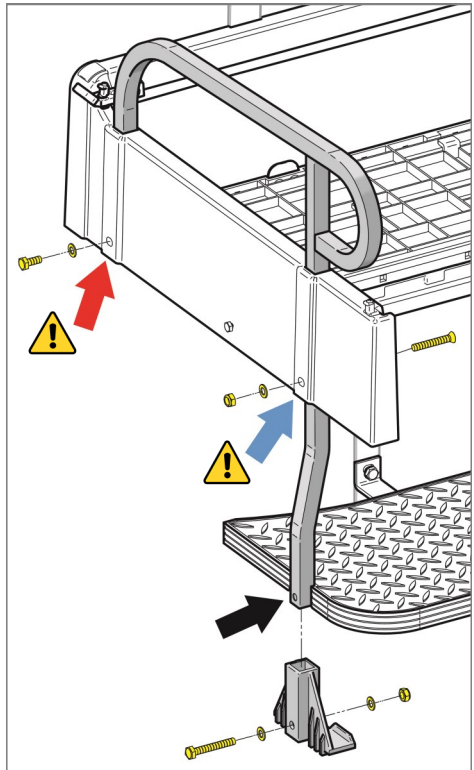

14. Slide the rear seat bottom onto the underside of the utility box deck until it clicks into place on the locking tabs (yellow).

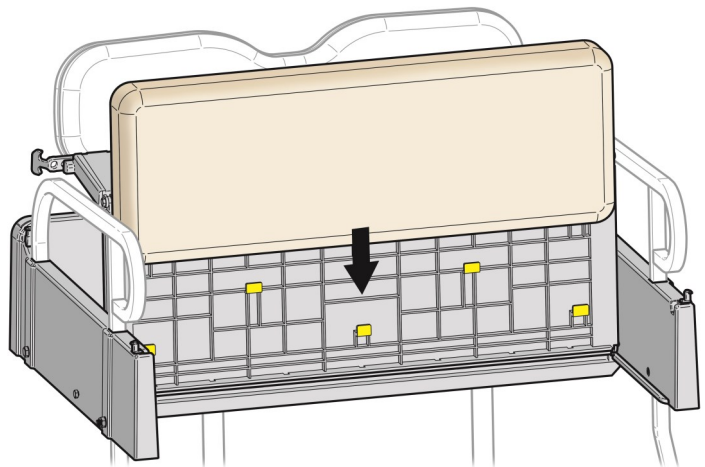

15. Lock the seat bottom into place with the (2) small retaining plates and (4) M6 x 15 Phillips Head Countersunk Screws (**Bag #5**).

**NOTE:** The retaining plates and screws may be installed on the utility box if not in Bag #5.

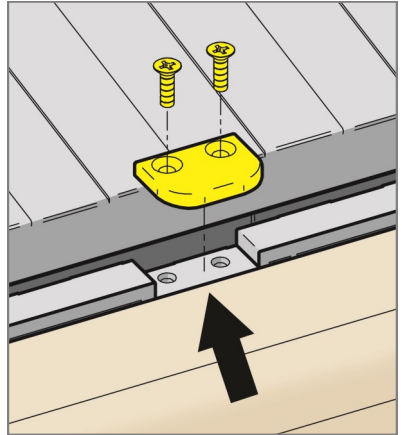

16. If reinstalling the OE rear struts, install them to the front seat back support frame using the Original Hardware (black arrows).
17. If installing struts for an extended top, remove the end caps from the front corners of the utility box (red arrow).

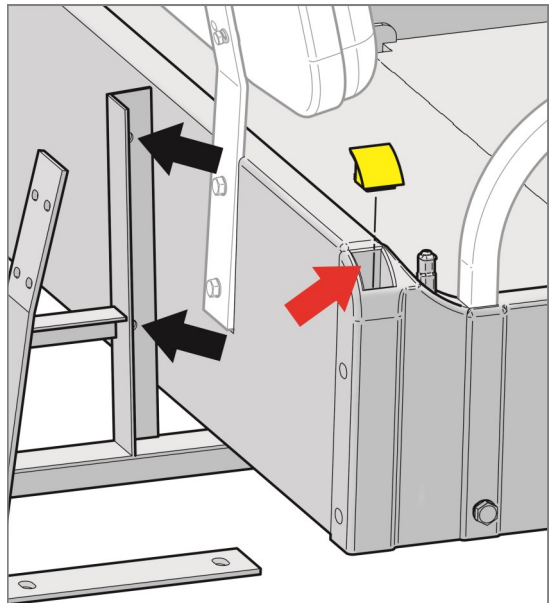

18. Insert the struts inside of the utility box where the end caps were removed. Fasten the struts to the box using the hardware preinstalled on the box. TOP-0108 rear struts are shown.

**NOTE:** RH0X 88" Tops require TOP-0108 rear struts.

19. Reinstall top using Original Hardware (if applicable).
20. Install the front seat back cushion using the Original Hardware.
21. Tighten all hardware.

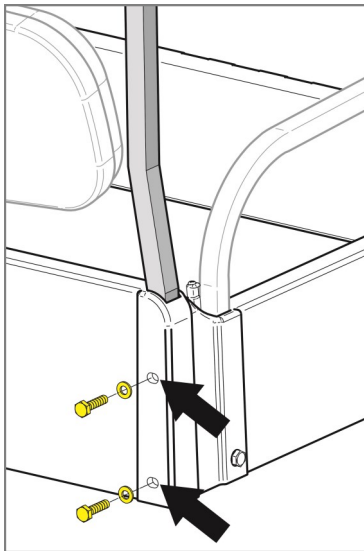

**RUGGED  
STARTS  
HERE**

This completes the installation of your  
RH0X 900 Series Seat Box Kit. Please enjoy safely!

Scan QR code or use the link below to  
view the installation video.

<https://vimeo.com/user39935056>

