



SEAT-441

Yamaha G14-G22

Rhino Seat Kit

Installation Instructions

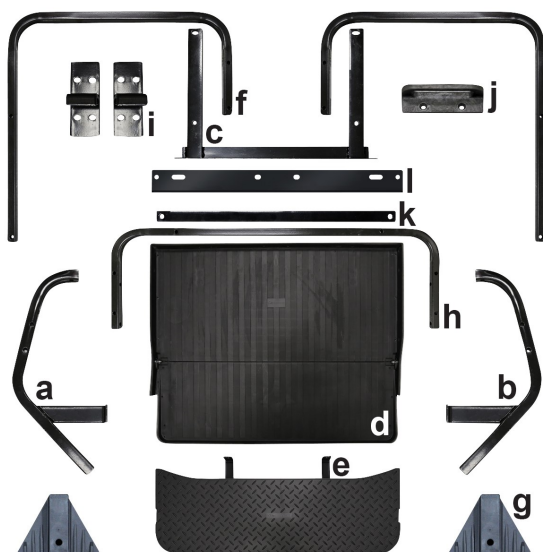

Contents of SEAT-441 Rhino Seat Kit:

- a (1 ea.) Front Seat Back Support, Driver Side
- b (1 ea.) Front Seat Back Support, Passenger Side
- c (1 ea.) Vertical Support Bracket
- d (1 ea.) Seat Platform
- e (1 ea.) Foot Plate
- f (2 ea.) Handrails
- g (2 ea.) Foot Plate Support Brackets
- h (1 ea.) Rear Seat Back Support Frame
- i (2 ea.) Rear Seat Back Brackets
- j (1 ea.) Seat Bottom Handle
- k (1 ea.) Horizontal Alignment Bar
- l (1 ea.) Seat Platform Support Bracket
- m (1 ea.) Box of Hardware (Contents on Next Page)

NOTE: Yamaha G14-G19 carts require TOP-0108 Top Struts for OE Top (not included).

Caution: Please read through the instructions carefully. Installer is responsible for damage if instructions are not followed properly. Look behind each drill or cut location BEFORE YOU DRILL OR CUT. Installer is responsible for damage (i.e. drilling/cutting into a wiring harness, battery, fuel tank etc.). Extra installers will be helpful in some parts of the installation. Refer to vehicle's maintenance manual for torquing specifications on reused hardware.

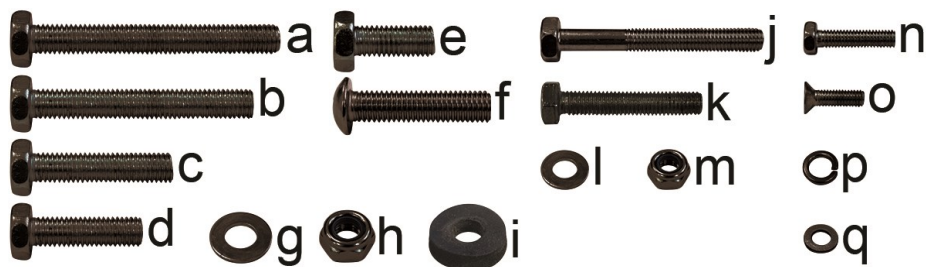

Contents of SEAT-441 Hardware Kit		Bag #1	#2	#3	#4	#5	#6
a	10mm x 80 Hex Head Bolts				2		
b	10mm x 70 Hex Head Bolts				4		
c	10mm x 45 Hex Head Bolts					2	
d	10mm x 35 Hex Head Bolts		2	2			
e	10mm x 25 Hex Head Bolts		2				
f	10mm x 45 Phillips Head Truss Bolts				2		
g	10mm Flat Washers		8	4	14	4	
h	10mm Nylock Nuts		4	2	8	2	
i	10mm x 8mm Thick Spacers				2		
j	8mm x 75 Shoulder Hex Head Bolts	2					
k	8mm x 45 Hex Head Bolts						2
l	8mm Flat Washers	4					4
m	8mm Nylock Nuts	2					2
n	6mm x 25 Hex Head Bolts					4	
o	6mm x 20 Phillips Head Countersunk Screws					2	
p	6mm Lock Washers					4	
q	6mm Flat Washers					4	

Tools Needed For Installation

- Sockets and Open Ended Wrenches: 10mm, 12mm, 1/2", 17mm
- Allen Wrenches: 5mm
- Phillips Screwdriver
- Drill and Drill Bit (5/16")
- Saw with Metal Blade (Optional)
- Rubber Mallet (Optional)

Installation Preparation

1. Engage parking brake.
2. Turn key OFF.
3. Electric Carts Only: Place Tow/Run Switch in Tow.
4. Remove top.

Carts with Non-Collapsible

Struts: The factory struts will need to be modified in order to be reused.

Carts with Collapsible Struts:

If reinstalling the top, keep the top attached to the front struts and prop up the rear of the top using a broom handle or similar tool. Retain hardware.

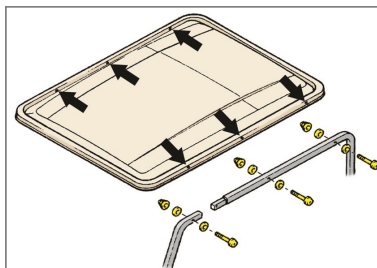

Carts with Non-Collapsible Struts
(Driver Side)

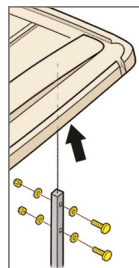

Carts with Collapsible Struts
(Driver Side)

5. Remove the front seat back cushions (red arrows). Retain hardware.
6. Remove rear struts and sweater basket (black arrows). Retain hardware.

Carts with Non-Collapsible Struts:

Sweater basket can be removed with rear struts. Requires TOP-0108 rear struts if reinstalling factory top.

Carts with Collapsible Struts:

Sweater basket can be removed separately or with the front seat back supports. Reuse factory rear struts if reinstalling factory top.

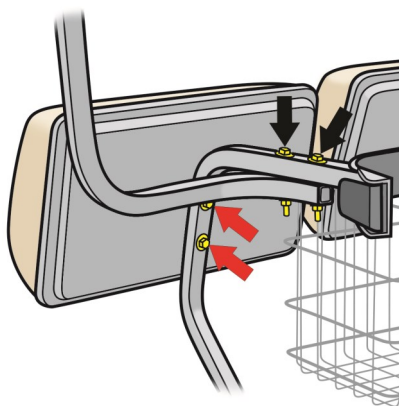

7. Remove the access panel. Retain rivets.

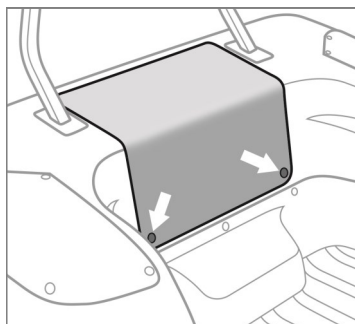

8. Remove the seat back support. Retain hardware and (2) rubber boots.

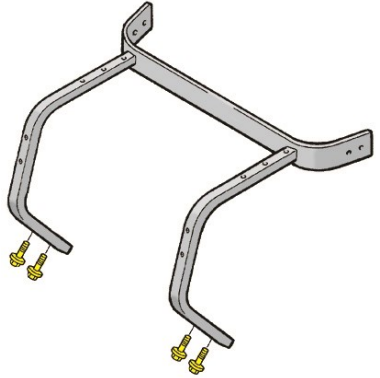

Rear Seat Kit Installation

1. Install the new front seat back support brackets where the original bracket was installed. Mount using Original Hardware and boots.

NOTE: The driver and passenger side brackets are different.

2. Reinstall the access panel using the Original Rivets.

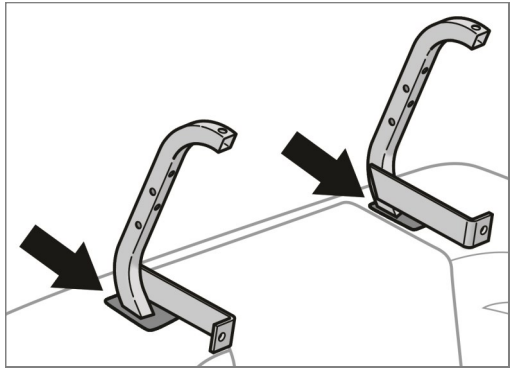

3. Remove the (2) bolts in the bagwell area. Use a 5/16" drill bit to enlarge the (2) holes that the hardware occupied. Drill completely through the frame.
4. Loosely fasten the vertical support bracket to the bagwell area using (2) 8mm x 75 Hex Head Bolts, (4) Flat Washers and (2) Nylock Nuts (**Bag #1**).

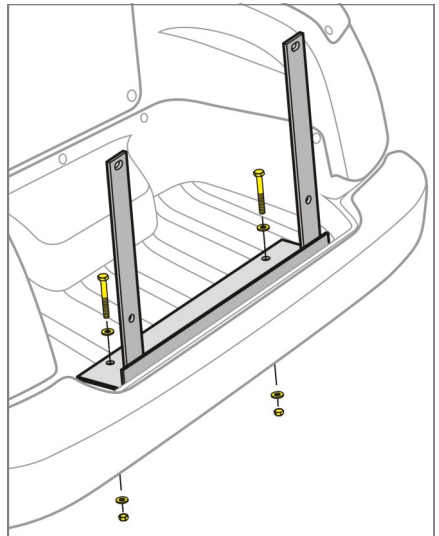

5. Loosely install the seat platform and seat platform support bracket to the front seat back support brackets using (2) 10mm x 35 Hex Head Bolts, (4) Flat Washers and (2) Nylock Nuts (**Bag #2**).

NOTE: Protect the rear body from scratches with a thick blanket or clean piece of cardboard. An extra installer is recommended on this step.

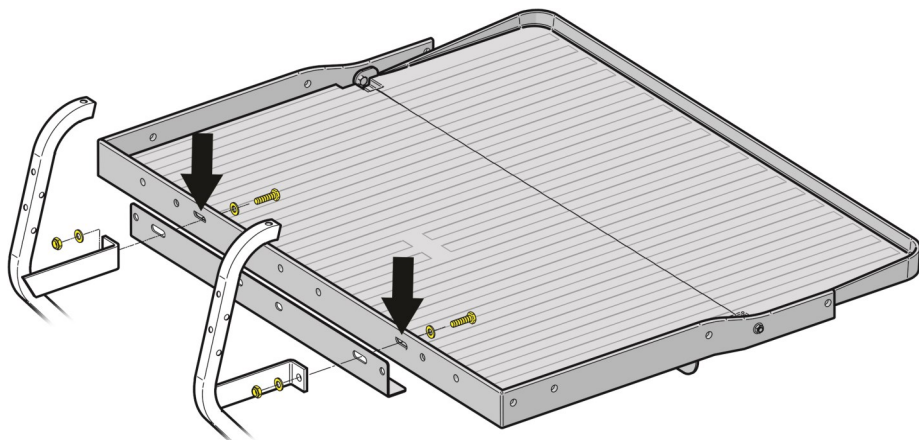

6. With the platform folded, loosely install the seat platform to the vertical support bracket using (2) 10mm x 25 Hex Head Bolts, (4) Flat Washers and (2) Nylock Nuts (**Bag #2**).

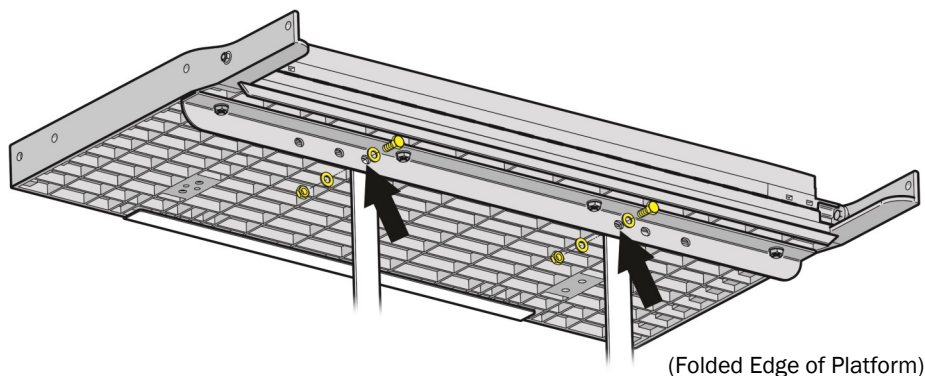

7. Loosely fasten the footplate to the vertical support bracket using (2) 10mm x 35 Hex Head Bolts, (4) Flat Washers and (2) Nylock Nuts (**Bag #3**).

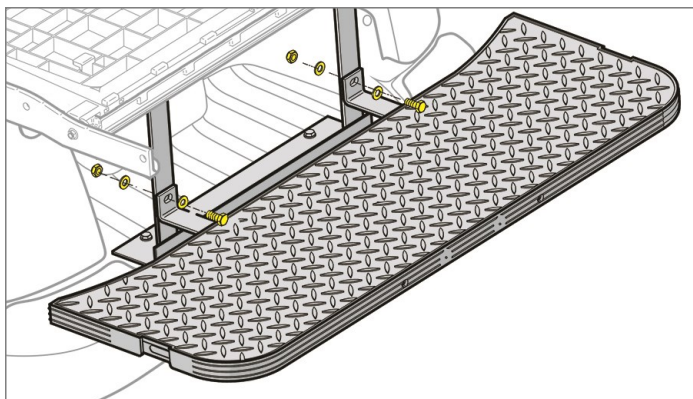

8. Loosely fasten the longer leg of a handrail to the rear most portion of the seat platform (blue arrow) using (1) 10mm x 45 Phillips Head Truss Bolt, (1) Flat Washer and (1) Nylock Nut (**Bag #4**).

9. Slide (1) footplate support bracket over the long end of the handrail until the holes align (black arrow). The bracket will cradle the footplate. Loosely fasten the bracket and handrail to the footplate using (1) 10mm x 80 Hex Head Bolt, (2) Flat Washers and (1) Nylock Nut (**Bag #4**).

10. Repeat Steps 8 and 9 for the opposite handrail.

11. Place the rear seat back support frame between the handrails. Loosely fasten the support frame to the bottom of the handrails and the seat platform (red arrow) using (2) 10mm x 70 Hex Head Bolts, (4) Flat Washers and (2) Nylock Nuts (**Bag #4**)

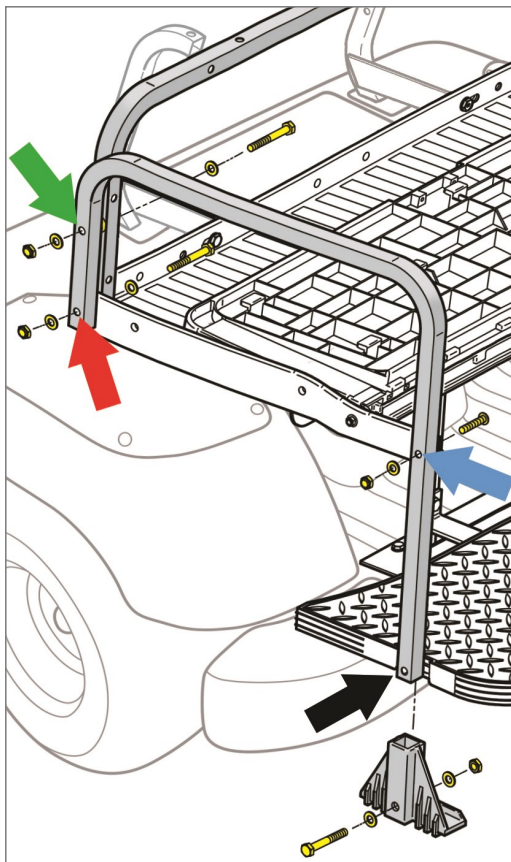

12. Loosely fasten the top of the handrails to the support frame (green arrow, page 6) using (2) 10mm x 70 Hex Head Bolts, (4) Flat Washers, (2) Nylock Nuts and (2) Spacers (**Bag #4**).
13. Install the front seat back cushion using the Original Hardware. Loosen the front seat back supports temporarily if the holes do not align. Hand tighten.
14. Install the horizontal alignment bar on the front seat back supports using (2) 8mm x 45 Hex Head Bolts, (4) Flat Washers and (2) Nylock Nuts (**Bag #6**).
15. Tighten all hardware.

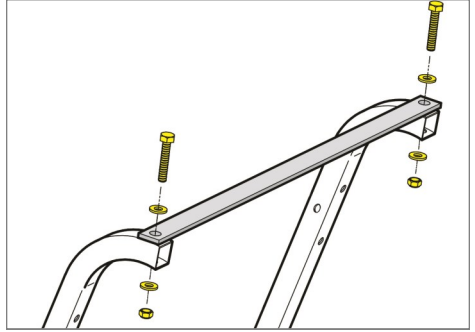

16. Install the rear seat back brackets to the rear seat back using (4) 6mm x 25 Hex Head Bolts, (4) 6mm Lock Washers and (4) 6mm Flat Washers (**Bag #5**). Hand tighten.

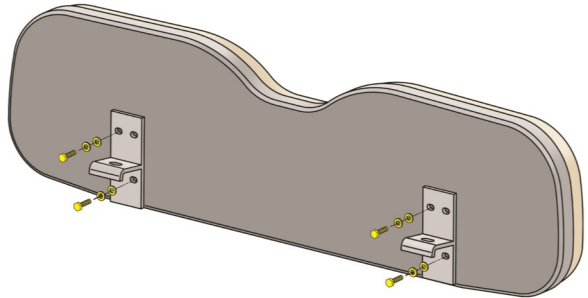

17. Install the rear seat back assembly to the rear seat back support frame using (2) 10mm x 45 Hex Head Bolts, (4) 10mm Flat Washers and (2) 10mm Nylock Nuts (**Bag #5**).

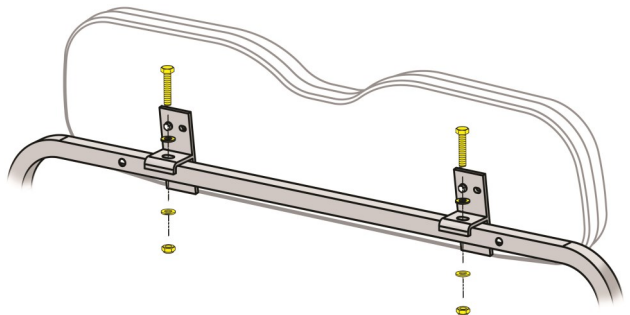

18. Align the recessed areas on the seat bottom cushion with the locking tabs on the seat platform (yellow). Slide the seat bottom onto the platform until it locks into place on the locking tabs.

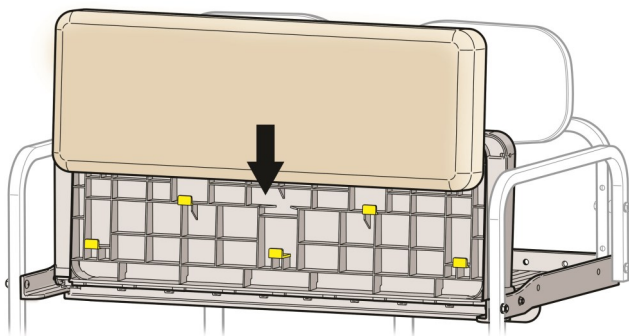

19. Fasten the handle to the seat frame using (2) **6mm x 20 Phillips Head Countersunk Screws (Bag #5)**. Hand tighten to lock the seat bottom into place.

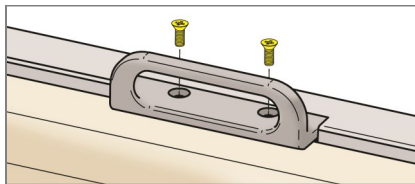

20. Carts with Collapsible Struts:
If reinstalling the OE rear struts install them to the front seat back supports (red arrows) using the Original Hardware.

Carts w/o Collapsible Struts or Extended Tops:

If reinstalling the OE top or adding a RHOX extended top, install TOP-0108 rear struts to the rear seat back support frame (black arrows). Modify the OE struts as shown to reuse as front and middle portions of struts to support top.

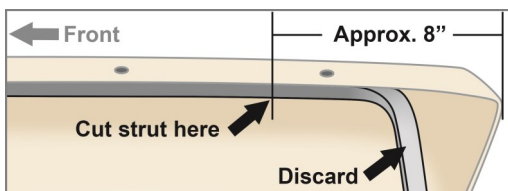
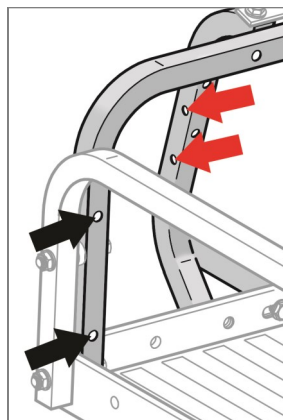

21. Reinstall top using Original Hardware (if applicable).



This completes the installation of your RHOX Rhino Seat Kit. Please enjoy safely!

Scan QR code or use the link below to view the installation video.

<https://vimeo.com/user39935056>